

The hard ground corebit designed & manufactured to meet the challenges of the toughest ground conditions.

- Diamond Impregnated replaceable cutters to suit a variety of ground conditions.
- Face discharge replaceable TC Jet Nozzles.
- TC gauge & Stabilizer wear protection.
- Body precision machined from AISI 4145H.
- API connections to suit IDS multi tool BHA's.
- Bespoke Design service available to meet individual requirements.
- Designed & manufactured in the UK by IDS.
- For more information contact sales@idsuk.com



© IDS 2020

See overleaf for technical details.

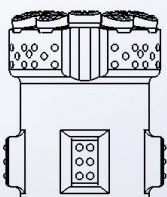

Full 360 deg carbide button wear protection, produced from single piece of AISI 4145 HMOD material.

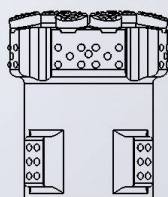

Full contact dome faced arrangement featuring improved directional cutting and stability.

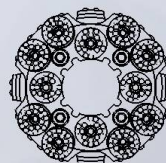



ROCK DESCRIPTION	UCS/Mpa	HARDNESS
Hard Limestone	25-50	HARD ABRASIVE
Schist		
Dolomites		
serpentine		
Andesites	50 to 100	HARD NON ABRASIVE
Diabase		
Dolomites		
Hard Schist		
Magnetite		
Marble		
Pegmatites		
Siliceous Limestone		
Syenites		
Amphibolite		
Basalts	100 to 200	VERY HARD
Diorites		
Gabbro		

IDEAL WORKING CONDITIONS

Twelve Replaceable (Anti Rotating) Segments

Using synthetic diamond media which has a distinct advantages over natural mined diamond, in that it is an engineered material, which has measurable, controlled physical properties. These include being able to control crystal friability and geometry, which are particularly important for optimum bit performance.

'S' Matrices Series 8 ('S8').

The matrix layer of these segments contains uniform distribution of these synthetic diamond particles, that are embedded in a powdered metal bond. Grit size and concentration of these synthetic diamond crystals, as well as relative hardness of the metal bond materials in which they are suspended, are all functions of the matrix type design.

Need to know more?

Contact IDS at sales@idsuk.com for more information relating to our Invictabit design or comparative products. Offering in house design manufacturing and working alongside the industry leading suppliers of HDD and Geotechnical tools spares and equipment.

