

IDS SPECIALISED DRILLPIPE - CAROUSEL FITTING

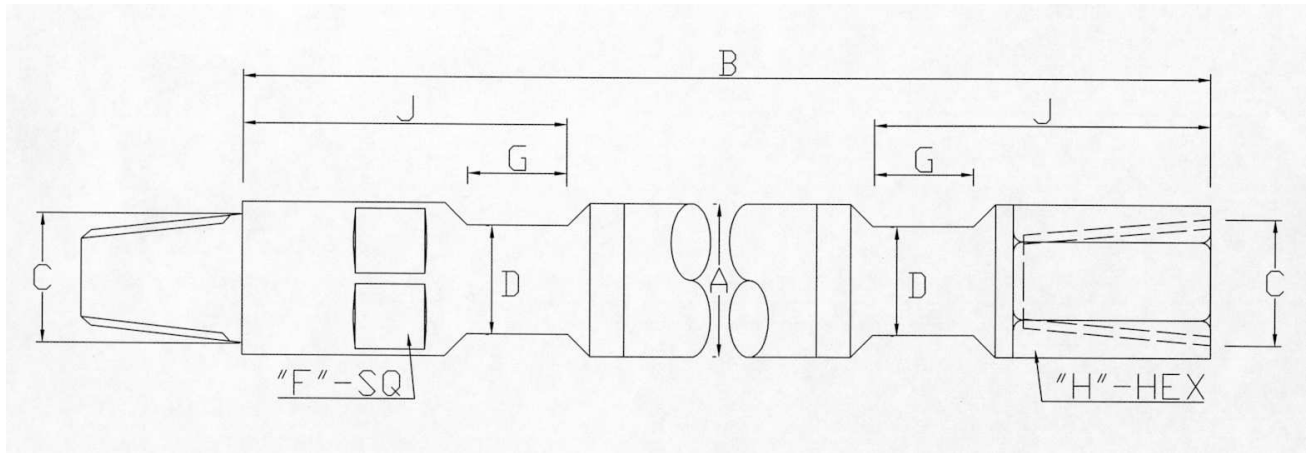

A	WALL THICK	B LENGTH	C				J		H-HEX	F-SQ	D		G		APPROX WEIGHT	PART NUMBER
			TOOL JOINTS		LENGTH SHOULDER		INS				INS					
			CONNS API SPEC (INS)	I.D. (INS)		INS		INS			INS					
INS.	INS.	FT / INS.		PIN	BOX	PIN	BOX			PIN	BOX	PIN	BOX	KG		
4.1/2	0.337	25'	3.1/2 REG	1.1/2	1.1/2	8.1/2	8.1/8	4	3.1/2	3.1/4	3.1/2	3.1/8	2.3/4	193	4533725	
4.1/2	0.375	22'	3.1/2 REG	1.1/2	1.1/2	8.1/2	8.1/8	4	3.1/2	3.1/4	3.1/2	3.1/8	2.3/4	188	4537522	
4.1/2	0.625	25'	3.1/2 REG	1.1/2	1.1/2	8.1/2	8.1/8	4	3.1/2	3.1/4	3.1/2	3.1/8	2.3/4	286	4562525	
4.1/2	0.625	22'	3.1/2 REG	1.1/2	1.1/2	8.1/2	8.1/8	4	3.1/2	3.1/4	3.1/2	3.1/8	2.3/4	250	4562522	
4.1/2	0.375	21'6"	3.1/2 REG	1.1/2	1.1/2	8.1/2	8.1/8	4	3.1/2	3.1/4	3.1/2	3.1/8	2.3/4	166	4537521	
4.1/2	0.625	21'6"	3.1/2 REG	1.1/2	1.1/2	8.1/2	8.1/8	4	3.1/2	3.1/4	3.1/2	3.1/8	2.3/4	321	4562521	
4.1/2	0.337	25'	2.7/8 IF	2.1/8	2.1/8	8.1/2	8.1/8	4	3.1/2	3.1/4	3.1/2	3.1/8	2.3/4	190	4537251	
4.1/2	0.625	25'	2.7/8 IF	2.1/8	2.1/8	8.1/2	8.1/8	4	3.1/2	3.1/4	3.1/2	3.1/8	2.3/4	282	4562502	
5	0.500	25'	3.1/2 REG	1.1/2	1.1/2	8.1/2	8.1/8	4	3.1/2	3.1/4	3.1/2	3.1/8	2.3/4	320	5050025	
5	0.375	25'	3.1/2 REG	1.1/2	1.1/2	8.1/2	8.1/8	4	3.1/2	3.1/4	3.1/2	3.1/8	2.3/4	259	5037525	
5	0.375	21'6"	3.1/2 REG	1.1/2	1.1/2	8.1/2	8.1/8	4	3.1/2	3.1/4	3.1/2	3.1/8	2.3/4	250	5037521	
5	0.375	24'	4 FH	2.13/16	2.13/16	8.1/2	8.1/8	4	3.1/2	3.1/4	3.1/2	3.1/8	2.3/4	248	5037524	
5	0.750	25'	3.1/2 REG	1.1/2	1.1/2	8.1/2	8.1/8	4	3.1/2	3.1/4	3.1/2	3.1/8	2.3/4	442	5075025	
5.1/2	0.500	18'	4 FH	2.13/16	2.13/16	8.1/2	8.5/8	5	4.1/2	4.1/2	4.1/2	2.15/16	3.9/16	250	5550018	
5.1/2	0.500	25'	4 FH	2.13/16	2.13/16	8.1/2	8.5/8	5	4.1/2	4.1/2	4.1/2	2.15/16	3.9/16	328	5550025	
5.1/2	0.500	20'8"	4 FH	2.13/16	2.13/16	8.1/2	8.5/8	5	4.1/2	4.1/2	4.1/2	2.15/16	3.9/16	274	5500208	
5.1/2	0.375	25'	4 FH	2.13/16	2.13/16	8.1/2	8.5/8	5	4.1/2	4.1/2	4.1/2	2.15/16	3.9/16	275	5537525	
5.1/2	0.500	25'	3.1/2 BECO*	1.1/2	1.1/2	8.1/2	8.5/8	5	4.1/2	4.1/2	4.1/2	2.15/16	3.9/16	328	5550251	
6.1/4	0.500	25'	4 FH	2.13/16	2.13/16	8.1/2	8.5/8	5	4.1/2	4.1/2	4.1/2	2.15/16	3.9/16	380	6255025	
6.1/4	0.500	20'8"	4 FH	2.13/16	2.13/16	8.1/2	8.5/8	5	4.1/2	4.1/2	4.1/2	2.15/16	3.9/16	318	6255028	

* NOT API SPECIFICATION
FRICTION WELDED AND STRESS RELIEVED UP TO 5.1/2 O.D